

## APP



Google Play and the Google Play logo are trademarks of Google Inc.



Apple and the Apple logo are trademarks of Apple Inc.



Download the soundcore app to experience adaptive noise cancelling, HearID sound, custom EQ, firmware update, and more exciting features.

If your earbuds cannot connect with the soundcore app, re-install the app or update it to the latest version in your mobile app store.

Click this link to download: <http://dl-soundcore.soundcore.com/qcdl?flow=soundcore>

## OVERVIEW

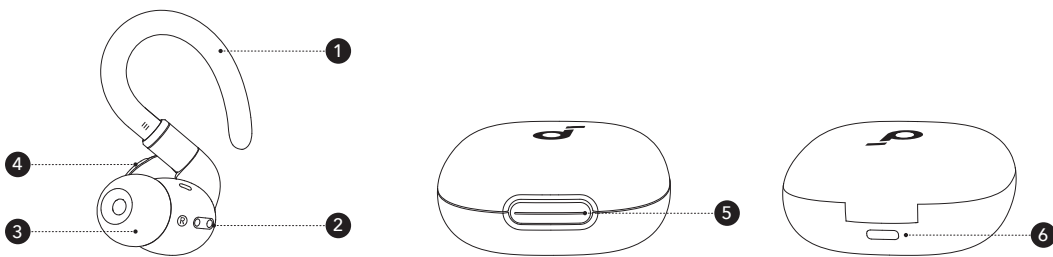

1. Adjustable & Rotatable Earhook
2. Charging Contactors
3. Eartip
4. Multi-function Button
5. Charging Case Button
6. USB-C Charging Port

## PAIRING

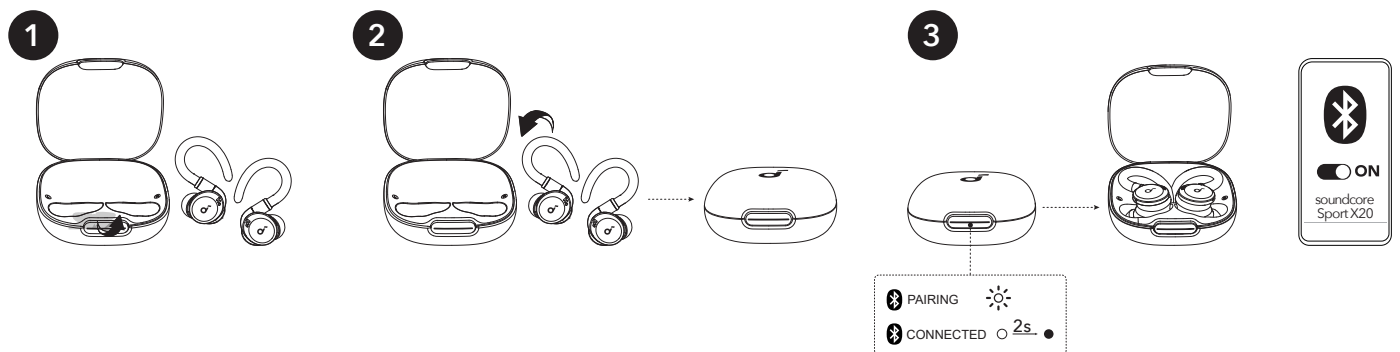

After removing the insulation stickers on the earbuds, return earbuds to the charging case, **then activate Bluetooth pairing by closing and reopening the case lid**. Subsequently, the earbuds will automatically power on and enter Bluetooth pairing mode. Select "**soundcore Sport X20**" from your device's Bluetooth list when connecting for the first time.

- When pairing, the LED light strip will start flashing white. After the pairing is successful, the LED light strip will stay on for 2 seconds and then go off.

- \* When taken out, the earbuds will automatically power off after 30 minutes if they are not connected. The duration can be set in the soundcore app.

## WEARING

1

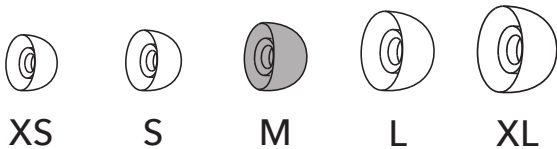

2

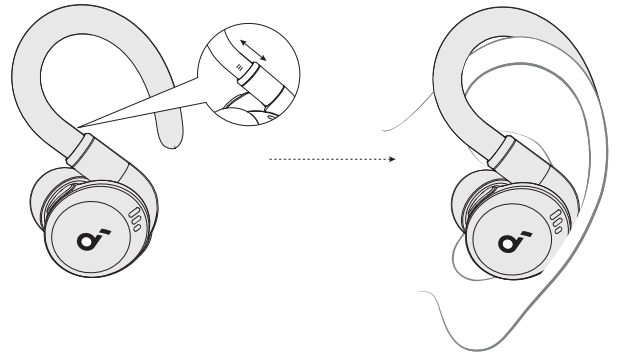

1. Choose the ear tips that fit your ears best and take a fit test in the soundcore app to ensure you get the best ANC performance.
2. Lift and bend the earhooks around your ears for a secure and comfortable fit.
3. Insert the earbuds into the inner canal of your ears and turn gently until you find the most comfortable and secure position.

**Tips: For a more comfortable wearing experience, hold the stems of the adjustable and rotatable earhooks and stretch them to an appropriate length.**

- \* Dust, earwax or other debris can accumulate in the earbuds. To maintain optimal sound quality, regularly clean your earbuds via using a cotton swab slightly moistened with rubbing alcohol to gently wipe the metal mesh filter under the rubber ear tips.

## CHARGING

1

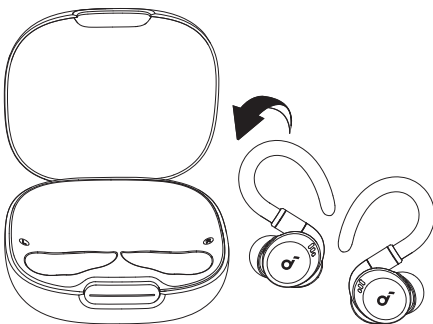

2

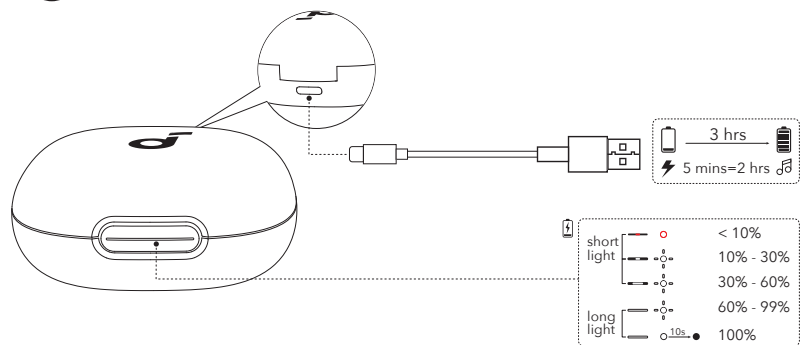

1. Place the earbuds in the charging case and close it.
  - Fully dry off the earbuds and the USB-C charging port before charging.
2. Connect the charging case to a power supply by using the provided USB-C charging cable.

## PAIRING WITH ANOTHER DEVICE

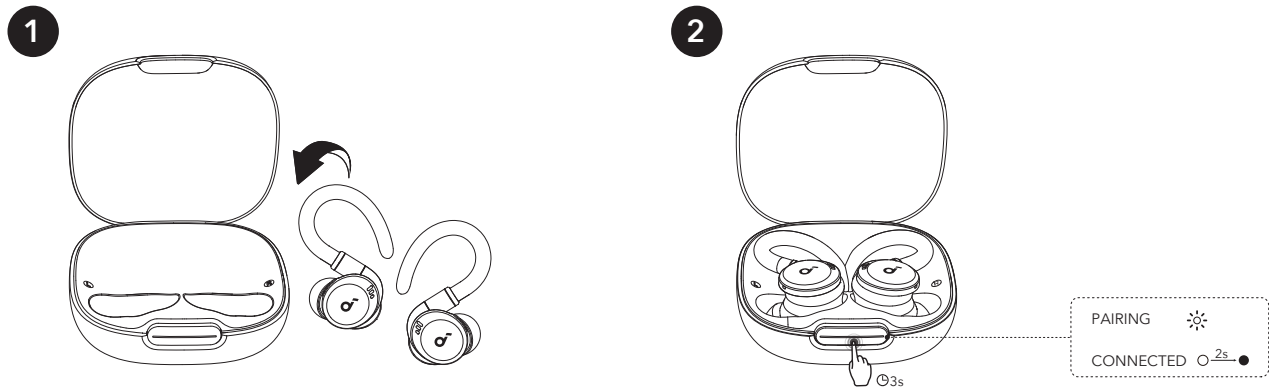

To pair with another device, place the earbuds in the charging case and leave the case open. Press and hold the charging case button for 3 seconds until the LED light strip flashes white rapidly.

## CONTROLS

**TWS**

**MONO**

		TWS mode	Mono mode
🎵	Play / Pause	Press once (L/R)	Press once
	Previous track	Press twice (L)	/
	Next track	Press twice (R)	Press and hold for 2 seconds
☎️	Answer a call	Press once (L/R)	Press once
	Hang up	Press and hold for 2 seconds (L/R)	Press and hold for 2 seconds
	Reject a call	Press and hold for 2 seconds (L/R)	Press and hold for 2 seconds
🔊	Switch ambient sound modes (ANC / Transparency)	Press and hold for 2 seconds (L/R)	/

\* You can also customize controls in the soundcore app.

## AMBIENT SOUND

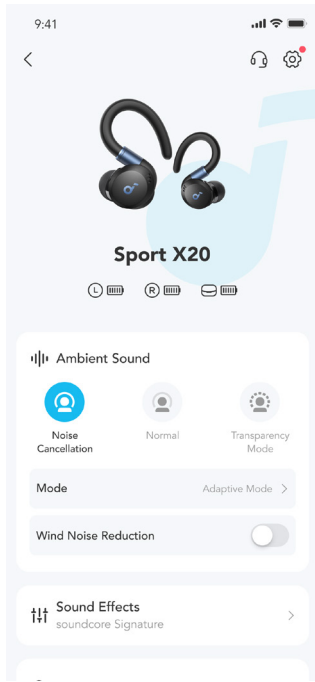

You can select Noise Cancellation, Normal, or Transparency mode in the soundcore app.

- **Adaptive ANC:** Optimize noise cancellation by adapting to the surrounding environment.
- **Transparency:** Stay aware of your surroundings while listening to music.

## POWERING ON OR OFF

### With the Charging Case

Once connected successfully in first-time use, the earbuds will automatically reconnect to your device every time you open the charging case, as long as you haven't deleted the pairing history from your device. To power off, return both earbuds to the charging case and close it.

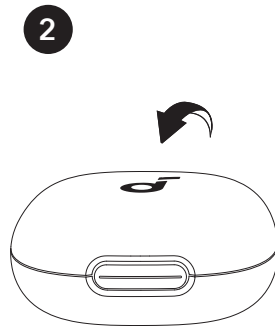
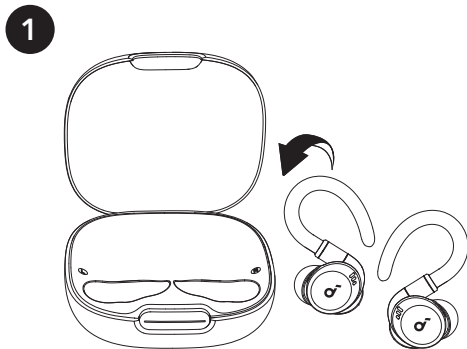

\* When returning the earbuds to the charging case, make sure that you carefully align the charging contactors between the earbuds and charging case. If either earbud is successfully back into the case, the LED light strip will light up in white and then go off.

## Without the Charging Case

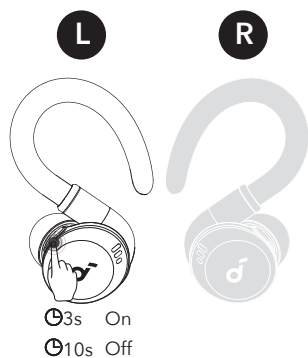

To power on a single earbud, press and hold the multi-function button of the corresponding earbud for 3 seconds. To power off a single earbud, press and hold the multi-function button of the corresponding earbud for 10 seconds.

## RESET

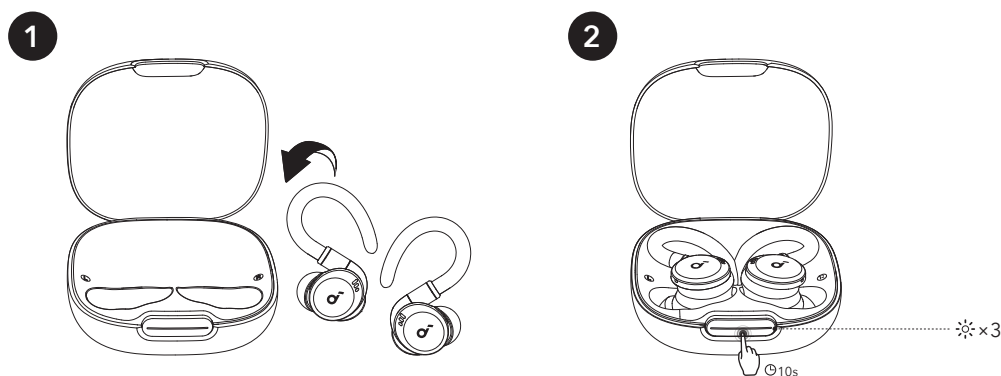

You might need to reset the earbuds if you experience any connectivity problems or function issues.

Place the earbuds in the charging case and leave the case open. Press and hold the charging case button for 10 seconds until the LED light strip flashes white rapidly three times.

## LED LIGHT GUIDE

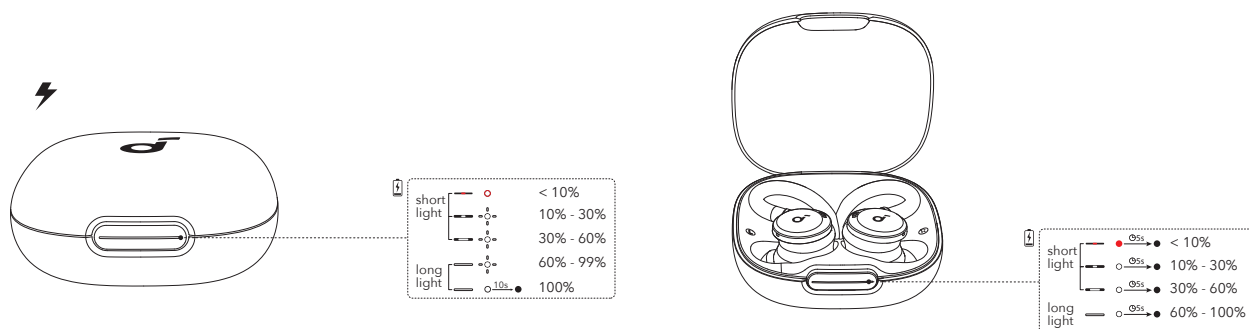

✨	Flashing white rapidly	● (flashing red)	Flashing red slowly
● (flashing white)	Flashing white slowly	● (flashing red)	Steady red
○	Steady white	● (flashing red)	Light off

## FIRMWARE UPDATE

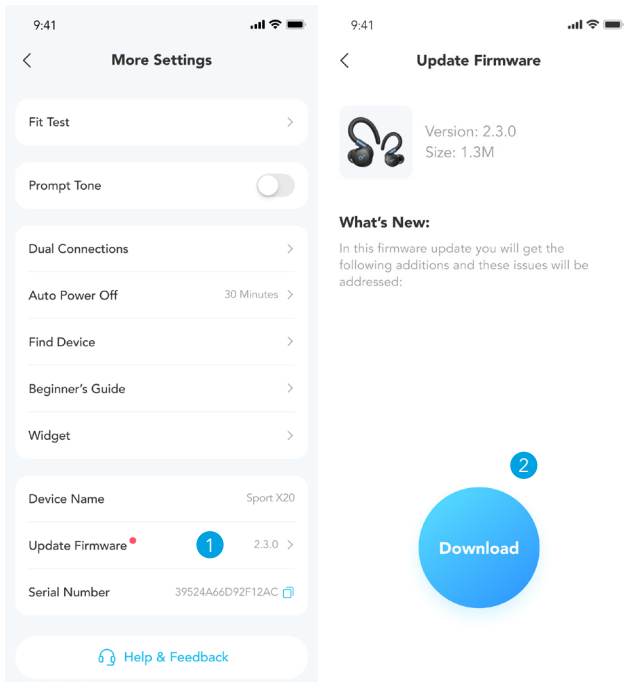

You will be informed once a new firmware version is detected when you connect the earbuds to the app. Ensure the earbuds are placed in the charging case and the case remains open until the firmware update is complete. During the update, ensure the earbuds are being charged and avoid any usage.

## SPECS

Specifications are subject to change without notice.

Input	5V $\equiv$ 0.45A
Output	5V $\equiv$ 0.3A(0.15A per port)
Battery capacity	580mAh / 2.158Wh
Playtime (with ANC off)	12 hours / 48 hours
Playtime (with ANC on)	7 hours/ 28 hours
Charging time	Full Charging Time for Earbuds: 1.5 hours Full Charging Time for Charging Case: 3 hours
Driver unit	11mm Dynamic Driver
Frequency response	20-20KHz
Impedance	16 $\Omega$
Waterproof rating (earbuds)	IP68
Bluetooth version	Bluetooth 5.3
Bluetooth range	10m

## Customer Service



service@soundcore.com  
support.mea@soundcore.com (For Middle East and Africa Only)  
support@anker.com ( 日本 )

+1 (800) 988 7973 (US/Canada)  
+44 (0) 1604 936200 (UK)  
+49 (0) 69 9579 7960 (DE)  
03 4455 7823 ( 日本 )  
+86 400 0550 036 ( 中国 )  
+82 02-1661-9246 ( 한국 )  
+971 529750842 (Middle East & Africa)  
+971 8000320817 (UAE)  
+966 8008500030 (KSA)  
+965 22069086 (Kuwait)  
+20 8000000826 (Egypt)  
+61 3 8331 4800 (Australia)  
+90 (850) 460 14 14 (Türkiye)  
+8 (800) 511-86-23 (Russia)  
+91 18003138831 (India)



Hereby, Anker Innovations Limited declares that this device is in compliance with The Product Security and Telecommunications Infrastructure (Security Requirements for Relevant Connectable Products) Regulations 2023. For the Statement of Compliance, visit the website: <https://uk.soundcore.com/pages/psti-related>.